

A photograph of an elegant hallway. The hallway features a light-colored wooden floor, white walls with decorative moldings, and a large arched doorway at the end. A chandelier hangs from the ceiling. On the right side, there is a dark green table with two ornate, patterned vases. On the left side, there is a dark wooden cabinet with a white decorative panel. The overall atmosphere is classic and sophisticated.

Child's play

It's not easy striking a balance between an elegant home and a place where kids can be kids, but this Melbourne family got it in one.

STORY JUDY OSTERGAARD | PHOTOGRAPHY DEREK SWALWELL

Liz, Madeline and Will Haldane in the kitchen/living area. Rangehood by Qasair. Candelabra from The Works. Bar stools from Coco Republic. Rug by Designer Rugs. **OPPOSITE** The wide entry hall is the perfect place to display the family's beloved heirloom grandfather clock and hall table. Chandelier from Danielle Trippett Interior Design & Decoration. Mirror from Giltwood Antiques. Urns from Chinois For Living. Osborne & Little Dahlia Trail wallpaper. For Where to Buy, see page 204.



How they live

"The amount of space we now have is what makes this house so great," says Liz. "The children can have friends around and even if they all stay indoors, you never have the feeling of the little darlings being underfoot!" The versatility of the design is also a plus for the family. "The kitchen benches are used for homework and play time too. And the wide central hallway can be transformed into an entertaining area simply by adding a couple of trestle tables," says Liz.

Work was about to get underway on the renovation of their three-bedroom home in inner-city Melbourne when Clyde and Liz Haldane learnt they were expecting their third child. Despite the advanced stage in the renovation process, they went back to the drawing board to include an extra bedroom and more living space.

When the Haldanes bought the Victorian-era house in late 2005, it was in an unkempt state. "A series of small rooms had been added on, but the layout was disjointed, with no central point," says Liz.

So the couple called on design and construction company Ashcroft Conservatories to renovate as well as add a stylish, modern extension. This would incorporate a wide glass-roofed hallway, leading from the original hall to an open-plan living/dining area and kitchen. And, when the space underneath the addition was excavated, all of the family benefited: the children – Andy, seven, Will, five, and Madeline, two – gained a playroom and their parents a wine cellar.

As the construction work finally began, Liz realised that a unified decorating scheme was the key to successfully marrying >



‘The brief was to deliver a house that was at once elegant and – for want of a better word – child-proof.’ LIZ HALDANE



Classic cabinetry, marble benchtops and Victorian-inspired tapware and sinks from Manorhouse help to blend the modern kitchen with the original architecture. Marble splashback, benchtops and floor tiles, all RMS Natural Stone and Ceramics. Stove by Smeg. **OPPOSITE TOP** The light-filled dining area looks out to the garden. Grange dining suite from Domo Collections. **OPPOSITE BOTTOM** The furniture in the living area offers lots of storage. Grange cabinets, coffee table, sideboard and chair, all Domo Collections. Clock from In-Ex Living. Rug by Designer Rugs. Sofas, upholstered in Chivasso Icons Primo and Chivasso Our Stripe, both Danielle Trippett Interior Design & Decoration. For Where to Buy, see page 204.

Smart storage

"[Interior designer] Danielle Trippett has done a great job of balancing prettiness with toughness," says Liz. "A lot of the furniture has dual uses: the Grange chests, coffee table and console in the family room all double as toy storage. It's great to be able to quickly and easily clear away the children's clutter and have some adult time in an adult space."





THIS PAGE AND OPPOSITE TOP In the main bedroom, patterned and textured fabrics are layered for a look that is both elegant and cosy. Nina Campbell Huguenot Stripe wallpaper. Bedhead in Etamine Ramage. Bolster in Lorca Ludivine. Cushion in Lorca Roxanne. Bedlinen by Linen & Moore. Bedside tables, lamps and chandelier from Danielle Trippett Interior Design & Decoration. Curtains in Etamine Silk Stripe. Chaise in Lorca Ludivine.

OPPOSITE BOTTOM In Madeline's bedroom, charming floral prints create a look that she is sure to love for years to come. Jane Churchill Blossom wallpaper. Curtains and quilt in Jane Churchill Blossom Flower Fairies. For Where to Buy, see page 204.

Colour palette



Dulux Antique White U.S.A



Wattyl Chalk Beige

Add a dash of...



Haymes Somerset



Porter's Paints Moulin Rouge

A soft mint and a creamy pink would complement the upholstery and curtains.



< the contemporary and traditional sections of the home. Her brief to interior designer Danielle Trippett was “to deliver a house that is at once elegant and – for want of a better term – child-proof,” says Liz. The colour palette, a mix of aqua, taupe and cream, was inspired by the sunlight pouring into the extension through the lantern windows. “I wanted to create a fresh feel,” says Danielle.

In the original part of the house, the sitting room was transformed into a parents’ retreat that can double as a guestroom when required. In a departure from the airy vibe of the living area, Danielle created a more intimate, ‘gentleman’s club’ atmosphere for this room, with red striped wallpaper, chocolate-coloured furniture and luxe touches of gold.

As a finishing touch to the project, the garden was also given a makeover. Landscape designer Don Thompson of Gardenridge created two tiers to work with the gentle slope of the land, one housing the pool and the other a cubby house and rainwater tanks.

“It took time, but we got what we wanted,” says Liz. “The formal rooms are stately but not prissy, and the casual areas are beautiful yet family-friendly. It’s the perfect balance of form and function.” >

Ashcroft Conservatories, Moorabbin, Victoria; (03) 9532 1373 or www.ashcroft.com.au. Danielle Trippett Interior Design & Decoration, Albert Park, Victoria; (03) 9686 3177 or www.danielletrippett.com.

H&G houses

THIS PAGE AND OPPOSITE TOP

The rich red, chocolate and gold palette in this formal living room is in striking contrast to the rest of the house. Nina Campbell Annesbrook Stripe wallpaper. Sofa bed upholstered in Mulberry Home Daisy Chenille. Cushions in Mulberry Home Jester. Side tables, mirror, coffee tables and chairs, all Danielle Trippett Interior Design & Decoration.

OPPOSITE BOTTOM Like the house, the garden is designed for high impact and easy maintenance. Landscaping by Gardenridge. **For Where to Buy, see page 204. H&G**



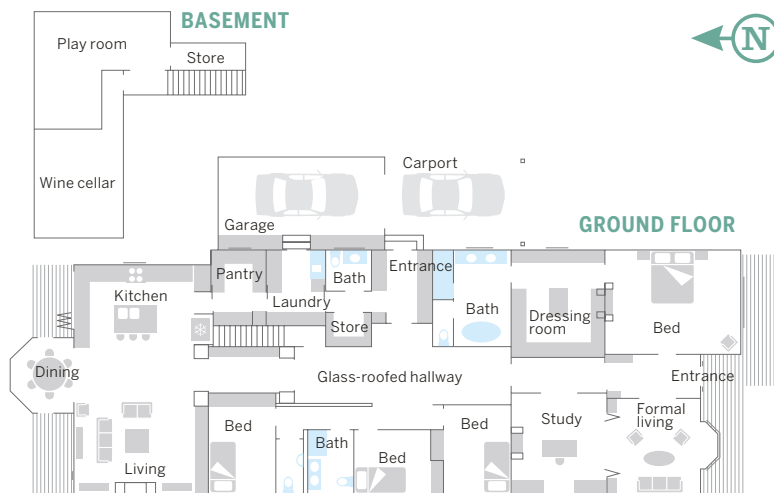

‘It took time, but we got what we wanted. The formal rooms are stately but not prissy, and the casual areas are beautiful yet family-friendly.’

LIZ HALDANE

